

Y-type Angle Seat Valve

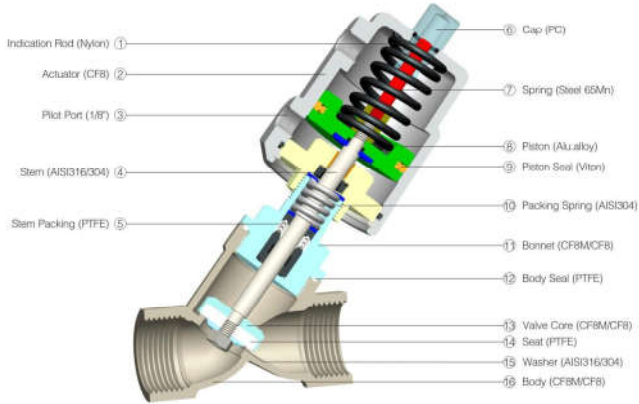

Function Principle

Valve stays closed(open) by spring force in its normal state. When piston is actuated by compressed air, valve becomes opened (closed). For double acting type, valve is opened and closed by compressed air.

Advantages

1. Large flux, low resistance, prevent water-hammer.
2. Y-type raises flux by 30% and make flow more smooth.
3. Long working life.
4. The stem adjusts and lubricates itself automatically, minimizing needs for maintenance.
5. The stainless steel actuator can be rotated 360° for flexible uses.

Applications

- Brewery
- Textile dyeing
- Air separation
- Pharmaceutical
- Filling machines
- Chemical
- Sterilization
- EPS molding
- Environmental equipments
- Others

Technical Specification

- Operating pressure: 0-16bar (0-232psi)
- Control pressure: 3-8bar (43.5-116psi)
- Control fluid: Neutral gas, Air
- Body material: CF8M/CF8
- Seal material: PTFE
- Actuator material: CF8 (40mm-90mm Actuator), AL (125mm Actuator)
- Actuator size: 40mm, 50mm, 63mm, 90mm, 125mm
- Applicable fluid: Water, Alcohol, Oil, Fuel, Steam, Neutral gas or Liquid, Organic solvent, Acid and lye
- Fluid viscosity: Max 600mm²/s
- Fluid temperature: -10°C — +180°C
+25°C — +220°C
- Ambient temperature: -10°C — +60°C
- Control type: Normally closed, Normally open, Double acting
- Connection type: Threaded (BSP, BSPT, NPT), Welded, Flanged, Tri-clamp
- Leakage class: EN 12266 Class A

Y-type Angle Seat Valve

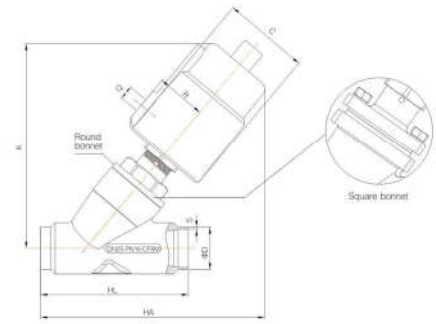
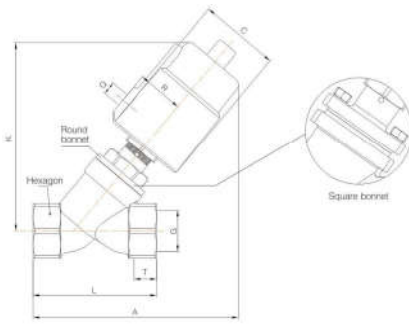

Main Dimension (Threaded Connection)

Size	Actuator (mm)	G	C	R	K	G	T	A	L	Hexagon
DN8	40	1/8"	50.5	27	112	1/4"	12	124	68	27
	50	1/8"	60	33	125		135			
DN10	40	1/8"	50.5	27	112	3/8"	12	124	68	27
	50	1/8"	60	33	125		135			
DN15	40	1/8"	50.5	27	112	1/2"	15	124	68	27
	50	1/8"	60	33	125		135			
DN20	50	1/8"	60	33	132	3/4"	16	140	75	32
	50	1/8"	60	33	136		150			
DN25	65	1/8"	75	41	162	1"	17	172	90	40
	65	1/8"	75	41	174		190			
DN32	90	1/8"	106	55	223	1 1/4"	21	235	116	50
	63	1/8"	75	41	175		190			
DN40	90	1/8"	106	55	223	1 1/2"	21	235	116	56
	63	1/8"	75	41	183		206			
DN50	90	1/8"	106	55	232	2"	22	250	138	69
	125AL	1/4"	170	85	300		305			
DN65 Square bonnet	90	1/8"	106	55	280	2 1/2"	26	275	178	85
	125AL	1/4"	170	85	300		320			
DN80 Square bonnet	90	1/8"	106	55	300	3"	27	340	210	100
	125AL	1/4"	170	85	305		340			

Main Dimension (Welded Connection)

Size	Actuator (mm)	G	C	R	K	HA	HL	DIN11850-2		DIN11850-3	
								φD	S	φD	S
DN15	40	1/8"	50.5	27	112	118	70	19	1.5	20	2
	50	1/8"	60	33	125	128					
DN20	50	1/8"	60	33	132	135	82	23	1.5	24	2
	50	1/8"	60	33	136	150					
DN25	63	1/8"	75	41	162	175	100	29	1.5	30	2
	63	1/8"	75	41	162	175					
DN32	90	1/8"	106	55	223	232	125	35	1.5	36	2
	63	1/8"	75	41	175	190					
DN40	90	1/8"	106	55	223	235	130	41	1.5	42	2
	63	1/8"	75	41	183	206					
DN50	90	1/8"	106	55	232	250	155	53	1.5	54	2
	125AL	1/4"	170	85	300	307					
DN65 Square bonnet	90	1/8"	106	55	280	300	270	70	2	-	-
	125AL	1/4"	170	85	330	360					
DN80 Square bonnet	90	1/8"	106	55	300	300	284	85	2	-	-
	125AL	1/4"	170	85	355	390					

Y-type Angle Seat Valve

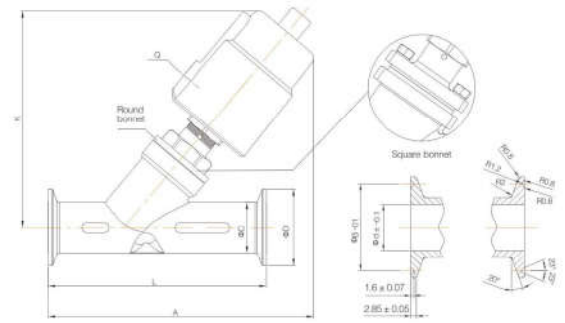
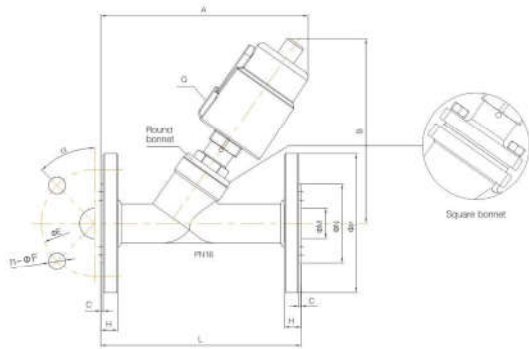

Flange specification: DIN2643/DIN2576/EN1092-1/HG20592; ISO/ANSI/DIN/JIS customization available.

Clamp Specification: ISO 2852; customization available.

Main Dimension (Flange Connection)

Size	Actuator (mm)	Q	A	B	L	C	H	φE	n-φF	φM	φN	φP	α
DN15	40	1/8"	135	125	130	2	14	65	4-14	18	45	95	45°
	50		145	140									
DN20	50	1/8"	165	140	150	2	14	75	4-14	19	56	105	45°
	63		170	145									
DN25	63	1/8"	190	175	160	2	14	85	4-14	26	65	115	45°
	90		190	188									
DN32	90	1/8"	230	235	180	2	16	100	4-18	31	78	140	45°
	63		206	190									
DN40	90	1/8"	250	240	200	3	16	110	4-18	38	84	150	45°
	63		235	195									
DN50	90	1/8"	277	245	230	3	16	125	4-18	48	100	165	45°
	125AL		330	310									
DN65 Square Bonnet	90	1/8"	330	280	290	3	18	145	4-18	66	120	185	45°
	125AL		375	330									
DN80 Square Bonnet	90	1/8"	380	305	310	3	20	160	8-18	78	135	200	22.5°
	125AL		420	395									
DN100 Square Bonnet	125AL	1/4"	420	395	350	3	20	180	8-18	86	155	215	22.5°

Main Dimension (Tri-clamp Connection)

Size	Actuator (mm)	Q	A	K	L	φC	φB	φd	φD
DN15	40	1/8"	130	115	80	19	27.5	15	34
	50		140	126					
DN20	50	1/8"	158	148	100	25	43.5	19	50.5
	63		165	140					
DN25	63	1/8"	188	166	130	32	43.5	27	50.5
	90		200	174					
DN32	90	1/8"	245	223	146	37	43.5	31	50.5
	63		210	175					
DN40	90	1/8"	255	223	160	40	56.5	33	64
	63		221	186					
DN50	90	1/8"	285	235	175	53	56.5	45	64
	125AL		325	296					
DN65 Square Bonnet	90	1/8"	325	280	278	75	83.5	66	91
	125AL		360	330					
DN80 Square Bonnet	125AL	1/4"	390	350	290	89	97	78	106